



Cloud User Manual



# G-ON2

2CH QHD | FHD DASH CAM

Quick User Guide rev02

This manual is including basic information of G-ON2 for simple use. For more details including all other official user manuals for G-ON product, please visit the GNET SYSTEM's website at: <https://www.gnetsystem.com/eng> → SUPPORT → DOWNLOAD.



## IMPORTANT SAFETY INSTRUCTIONS WARNING

© 2021 GNET SYSTEM CO.,LTD. or its subsidiaries All rights reserved. Under the copyright laws, this manual may not be copied, in whole or in part, without the written consent of GNET SYSTEM CO.,LTD. GNET SYSTEM CO.,LTD reserves the right to change or improve its products and to make changes in the content of this manual without obligation to notify any person or organization of such changes or improvements. Go to [www.gnetssystem.com](http://www.gnetssystem.com) for current updates and supplemental information concerning the use of this product.

GNET® and the GNET logo, are trademarks of GNET SYSTEM CO.,LTD. or its subsidiaries, registered in South Korea and other countries. GNET G-ON™, are trademarks of GNET SYSTEM CO.,LTD. or its subsidiaries. These trademarks may not be used without the express permission of GNET.

microSD® and the microSD logo are trademarks of SD-3C, LLC. Wi-Fi® is a registered mark of Wi-Fi Alliance Corporation.

- Do not expose the unit to electrical shock or debris.
  - This may cause product damage, fire, or electrical shock.
- Avoid use with excessive vehicle window tints or special auto glass.
  - Images may be blurry or distorted and may cause interference with the reception rate of the GPS.
- Do not modify or dismantle the device/ accessories.
  - We are not responsible for any damage to the device or vehicle due to user tampering.
- Never operate the device or adjust settings while driving.
  - Always keep your eyes on the road.
- Do not use liquids or chemicals to clean the product or accessories.
  - This may cause product damage, fire, or electrical shock.
- Please use a non-scratch lens cloth to clean the product and accessories.
  - Routinely clean camera lens for best results.
- In the absence of the external GPS, the device's date and time may be reset.
  - Please always check that the date/ time is correct.
- When parked for long periods of time in direct sunlight, a temperature increase inside the vehicle may result in a memory card corruption and/ or recognition error.
  - It is recommended to remove the memory card and store it out of direct sunlight during long periods of vehicle inactivity.
- Avoid high temperature or high humidity environment for normal operation of the product.
- Check the operation of the rear camera(s) periodically before driving.
  - Only the front camera will be captured in the event of a malfunction or defect.
- Warning: Operation of this equipment in a residential environment could cause radio interference.

## CAUTION FOR MEMORY CARD

- Overtime, memory degradation can occur and should be replaced periodically.
- To prevent incompatibility problems, please use only a genuine GNET memory card. The GNET memory cards are specifically designed to operate with our GNET systems and are covered under our warranty program.
- When a vehicle accident occurred, it is recommended to remove the memory card from the device and save the data to a computer immediately. When the memory card is full, the data will be overwritten, and the accident data will be lost.
- Please be sure to remove the memory card only after the recording LED is off. Otherwise, if removed too early, video data could be lost or corrupted. This can also shorten the card's lifespan.
- Please do not interchange / swap the memory cards between other products. Data may be erased and lost if the memory card is automatically formatted.
- It is recommended that the memory card be formatted at least twice a month for product and lifespan maintenance. For best results, please use the official SD Formatter ([www.sdcard.org](http://www.sdcard.org)).
- GNET System dash cameras can support memory card (SD) capacities ranging from 32GB to 512GB.
- When a new or used memory card is inserted into the device for the first time, the system will go into standby mode for 3 to 5 minutes. Please do not attempt to remove the memory card during standby mode or when the device is formatting the card.
- It is possible to format the memory card in the GNET application for Mac and PC. Please visit the GNET SYSTEM's website at:  
<https://www.gnetsystem.com/eng> → SUPPORT → DOWNLOAD

# PRODUCT COMPONENTS

## Basic Components



Main Camera



Rear Camera



User Manual



Hardwire kit



Screw, Wrench



Micro SD  
Memory card



Rear Camera  
connection cable



Wi-Fi dongle



External GPS

---

## Optional Product



Cigarette lighter power cable



OBD power cable



Cigarette lighter and OBD power cables are each sold separately.

- ※ The size and appearance of the components depicted above may be different from the real components.
- ※ Specifications and components may be changed without notice for quality assurance.
- ※ We highly recommend that a GNET Genuine Memory Card be used with all GNET products.

## NAME OF EACH PART

### Front camera

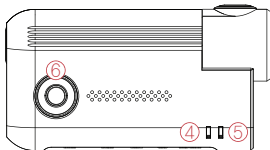
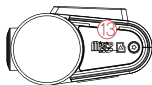
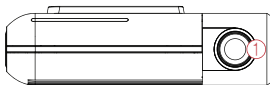
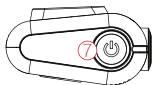
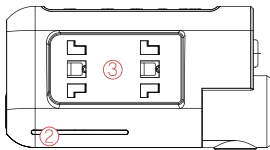
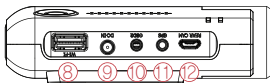

- |                        |                           |                          |
|------------------------|---------------------------|--------------------------|
| ① Front Camera Lens    | ⑥ Wi-Fi connection button | ⑪ External GPS Connector |
| ② Security LED         | ⑦ Power Button            | ⑫ Rear Camera Slot       |
| ③ Front camera bracket | ⑧ Wi-Fi USB dongle Slot   | ⑬ Micro SD card cover    |
| ④ GPS LED              | ⑨ Power connector (DC-IN) |                          |
| ⑤ REC LED              | ⑩ OBD2 Connector          |                          |

### Rear camera

- ⑭ Rear camera lens
- ⑮ Rear camera mount
- ⑯ Rear cable connection port

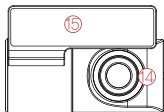
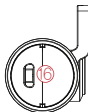

## SPECIFICATIONS

Image Sensor	SONY Starvis
Audio input	Built-in Microphone
Video Compression	H.265
Audio Compression	ADPCM
Resolution	Front : QHD (2560 X 1440), Rear : FHD (1920 X 1080)
Frame Rate	All cameras : Max. 30 FPS
Recording Time(Approx.)	128GB : 15hrs 6mins/ 64GB : 7hrs 30mins
3G/4G/Router (Optional)	Connect to withCLOUD via 3G/ 4G/ Router telecommunication
Wi-Fi (Optional)	Connect to GNET Smart phone application via Wi-fi dongle
G-Sensor	Event recording by External Shock
Speaker	Operation Status alarm / Voice guidance
External GPS	Synched with Google map, Keep track of location and Speed
Angle Of View	Front: 140°, Rear: 140°
Viewer	Windows XP/7/8/10, Mac, Support 32Bit / 64Bit, Synchronizing Google map with PC viewer is supported over Windows7 and explorer 10 as per Google' s policy.
Power	DC 12V - 24V
Allowable current of providing fuse	3A
Operation Temperature	-20°C ~ 60°C
Humidity	10~95%
Dimension(WxHxD, mm)	Front: 116x56x32, Rear: 44x38x28

※ Specifications and components are subject to change without notice for quality assurance.

# INSTALLATION

## Inserting Memory Card

**!** Please be fully aware of the orientation of the Micro SD Memory Card.

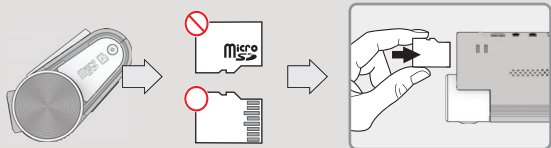

## HOW TO INSTALL DASHCAM

- 1 Assemble the front camera with the provided bracket in the order displayed. Make sure bracket is hooked correctly. Push and align it until a sound is heard. (①,②).

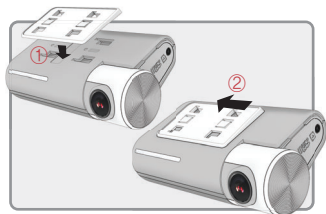

- 2 Once the bracket is secure, ensure that the memory card has been inserted. Proceed to peel the cover from the double sided tape on the bracket.

- 3 Install the front camera onto the front windshield of the vehicle making sure the angle and location is properly aligned.

**TIP:** The adhesive is extremely sticky. Avoid touching the adhesive to the windshield until the mount is properly positioned and aligned.

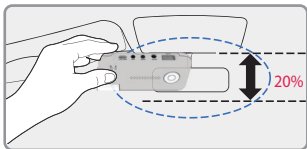

- 4 Depending on the vehicle, the front angle may be different. It is recommend to hold a dash cam vertically based on a regular passenger car.

- 5 Connect the power cable to the fuse box terminal inside the vehicle.  
(The connected terminal should be one which is always supplied power even when ACC power is turned off, such as emergency lights and/ or door racks.)  
Otherwise if using a cigar power cable, plug it directly into the vehicle cigar socket.

**CAUTION**

GNET strongly recommends having an experienced installer with the proper knowledge of electrical systems install the device. Incorrectly wiring the power cable can result in damage to the vehicle or the battery and can cause bodily injury.



**\*3-wire power cable**

Connect ACC to a fuse that does not flow when the vehicle is switched off  
Connect VCC to current fuse at vehicle start-off  
Connect GND to ground on the vehicle's body

**\*2-wire power cable**

Connect ACC and VCC to the terminal together, and change the setting from "3 wires" to "2 wires".

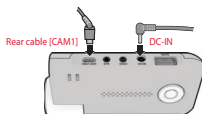

- 6 Connect the other side of the power cable to the DC-IN labeled slot of the front camera.

- 7 Attach the rear camera to the rear windshield of the vehicle and connect the cable to the front camera.

**WARNING**

When the cable is bent as shown in the picture, the data flow may be interrupted and a recording error may occur. Please be careful.

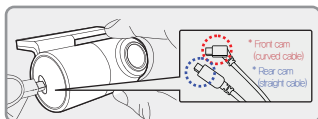

- 8 Carefully tuck the power cable and rear camera connection cable into the linings of the vehicle between the ceiling and glass.

**CAUTION**

GPS reception and terrestrial digital sensitivity may decrease depending on the navigation installed. When installing power cables and rear camera access cables, it is recommended that each cable be installed on the opposite side. For example, install the power cable facing the driver's side and the rear camera access cable facing the opposite seat.

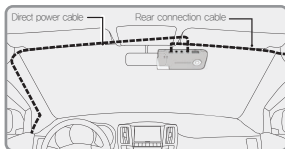

## SD CARD SECURE COVER

- 1 Open the SD card cover and insert the memory card.

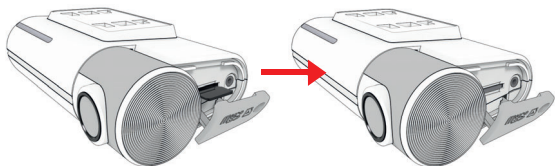

- 2 Then slide the SD cover into the hole as shown, and fasten the screw to the body.

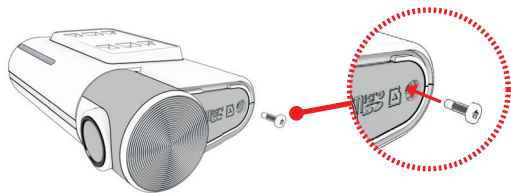

- 3 Covering the SD card is completed.

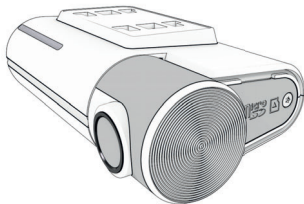

## Join the with Cloud member

<http://cloud.gnetsystem.com>

- 1 Please access the <http://cloud.gnetsystem.com> and click the "Sign up" button.

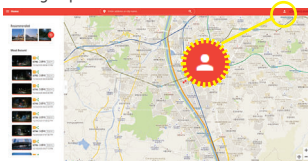

- 2 Put your information and click the "Sign up" button.



## Enroll the Vehicle/ Dashcam information

- 1 When you first login to the cloud server, click My Vehicles button from the menu.

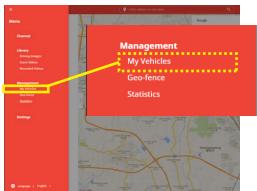

- 2 Click the + Add a Vehicle button and enroll the vehicle/ Dash cam information

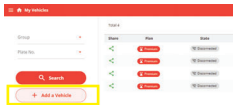

- 3 After you input the information, insert the serial number of your dash camera.

The dash camera serial number is mentioned at the front camera label

Once the vehicle registration is completed, the data of the dash camera will be stored in the withCLOUD server automatically.

A screenshot of the 'Add a Vehicle' form. It contains the following fields: 'Plate No.' (with a red underline), 'Group Name' (with a dropdown arrow), 'Vehicle Model', 'Driver Name', and 'Serial Number' (with a camera icon). At the bottom are 'OK' and 'CANCEL' buttons.

## WI-FI POWER ON/OFF

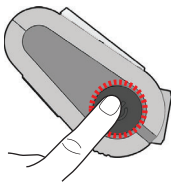

The Wi-Fi power is turned on/ off by pressing the power button twice.

- ! G-net application and cloud mode are not available while Wi-Fi power cuts.

## POWER ON/OFF

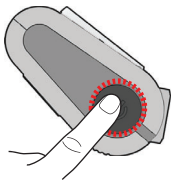

Turn off and restart the system.

- ! In case of turn the system off by holding the power button, you have to press and hold the power button again in order to restart the system.

## CHANGE INTO WI-FI OR CLOUD MODE

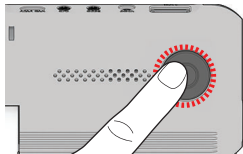

The Wi-Fi mode is changed to the CLOUD mode or the CLOUD mode is changed to the Wi-Fi mode if you press the Wi-Fi button for 5~6 seconds.

(At this time, when switching to the Wi-Fi mode or the CLOUD mode, DASHCAM is on and does not reboot)

# PLAYER MENU NAME



## ① Tool Box

- Save
- Open Folder
- Print
- Setting

## ② Google Map

When GPS and internet are connected, it will work normally.

## ③ Playlists and Information Display

## ④ GPS reception window

It can be used only when an external GPS is connected.

## ⑤ Video control popup

- Thumbnail
- Draw a lane
- View a video
- Split View
- PIP View
- Toggle (change) color

## ⑥ G-sensor (acceleration) graph

## ⑦ Speedometer

It can be used only when an external GPS is connected

## ⑧ Play a recorded video

- ▶ forward play
- ⏸ Pause
- 🔄 Repeat event video
- ⏮ ⏭ Previous, Next Event
- ⏪ ⏩ play frame by frame

## ⑨ Adjust playback speed ⑩ Sound control

## How to check G-sensor data

<Magnification of G-sensor data>



① The location of the image currently being played

② Numerical values and graphs of three-dimensional coordinate system information (G-sensor data)

- When you play the video, three-dimensional coordinate system information (G-sensor data) on the X-axis(progress direction), Y-axis (left-right), and Z-axis (height) of the image currently being played at the G-sensor data location is output.

# SMARTPHONE CONNECTION

## How to connect your smart phone - ANDROID

- 1 After installing the G-net application  
\* G-net application is not available while cloud mode is on.



- 2 Press the Wi-Fi® button on the dash camera to enter standby mode with the voice message "Registration standby mode" (last 2 minutes)

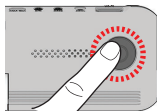

- 3 Touch the "+" button to search for the dash camera, then use the left and right arrows to select your dash camera and touch "Connection" on the screen.

For the first registration, [★] appears.

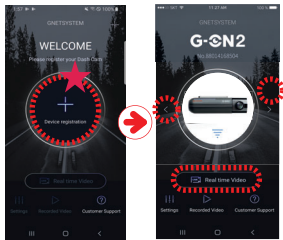

- 4 The registration of the dash camera is completed when you hear "User's connected".

\* If the connection fails due to a weak Wi-Fi signal, please re-insert the Wi-Fi dongle and press the Wi-Fi button on the device again. When standby mode is on, try it again.

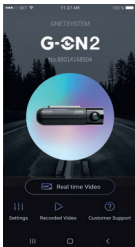

## How to connect your smart phone - iOS



- 1 After installing the G-net application  
\* G-net application is not available while cloud mode is on.
- 2 Press the Wi-Fi® button on the dash camera to enter standby mode with the voice message "Registration standby mode" (last 2 minutes)

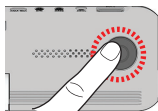

- 3 Go to settings and then Wi-Fi® on your mobile phone and enter the password [qwertyuiop] for the network that begins with GNET\_BB\_.

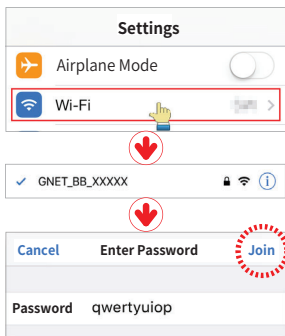

- 4 The registration of the dash camera is completed when you hear "User's connected".

\* If the connection fails due to a weak Wi-Fi signal, please re-insert the Wi-Fi dongle and press the Wi-Fi button on the device again. When standby mode is on, try it again.

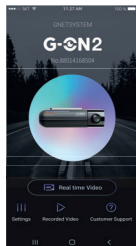

## APP Main Screen Description

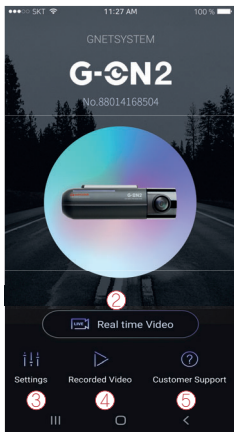

- ① This function allows you to connect other dash cams or delete the registered devices.  
※ Supported only on Android mobile
- ② Real-Time Video  
You can watch a real-time video.
- ③ Settings  
You can easily change settings via your smartphone.  
After changing the settings, press "Save" button to reboot the product (dash cam).
- ④ Recorded Video  
You can see a recorded video of the dash cam.  
The video that you need can be saved to the mobile device via download.
- ⑤ Customer Support  
You can get help with connection via customer support on app or you can get help by calling our customer support center.

## Precaution before connect the Smart phone

We provide Android and iOS platform.

Please search "GNET" on Google play or App store. Or use the QR code.



- Real time video and playback can be delayed depending on Smart phone specification.
- Do not handle the device while driving, it may cause serious accidents.
  - Please handle the device after parking/stopping.

# Warranty Card

Product	G-net Dash cam		Model	G-ON2
Serial Number			Purchasing date	
Consumer	Name		Tel	
	Address			
Vendor			Tel	
Period of free guarantee	Dash Camera : 1 Year Micro SD card : 3 months			

※ If you would like to repair the product, please contact by e-mail address [info@gnetssystem.com](mailto:info@gnetssystem.com)

## G-ON2 Line-up

**G-ON2i - Taxi**



**G-ON2T - Truck**

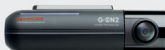

[www.gnetssystem.com/eng](http://www.gnetssystem.com/eng)  
 6F Lotte IT Castle II Gasan Digital 2ro 98,  
 Geumcheon-gu, Seoul, Korea  
[info@gnetssystem.com](mailto:info@gnetssystem.com)

